

ACACIA

PARK HEIGHTS

PROJECT LOCATION



- Dubai Hills Located within Mohammad Bin Rashid City .

SITE LOCATION



MASTER PLAN



Master plan Vision



Master plan Vision

PROJECT FEATURES



PROJECT FEATURE



PROJECT FEATURE



PROJECT FEATURE



PROJECT FEATURE



The residences at Acacia Park Heights seek to reconcile urban living with lush nature.

Buildings have been arranged to take full advantage of park views.

Private courtyards blur the boundary between residence and park edge.

PROJECT FEATURE



PROJECT FEATURE

PROJECT INTERIORS



The focal point of entry – embracing all visitors in a welcoming atmosphere of comfort.



Understated
comfort and
elegance.

LOUNGE/DINING



An entertaining delight.

DINING



Ease of use – a space complete with delightful + surprising design elements.

KITCHEN



A warm and embracing space, allowing complete relaxation.

MASTER BEDROOM



A worthy accompaniment to the bedroom. Timeless in expression.

MASTER BATHROOM

FLOOR PLANS

1 BEDROOM - T1A

BLOCK A, 8, C

LEVELS	UNITS
03	B-312
04	A-400, B-400, B-412, B-410, C-400
05	A-500, B-500, B-512, B-510, C-500
06	A-600, B-600, B-612, B-610, C-600
07	A-700, B-700, B-712, B-710, C-700
08	A-800, B-800, B-812, B-810, C-800

SUITE AREA
844 ^{sq.m} / 78.41 ^{sq.m}

TERRACE AREA
78 ^{sq.m} / 7.22 ^{sq.m}

TOTAL AREA
922 ^{sq.m} / 85.63 ^{sq.m}

LEVELS	UNITS
03	A-314, C-314
04	A-414, C-414
05	A-514, C-514
06	A-614, C-614
07	A-714, C-714
08	A-814, C-814

SUITE AREA
850 ^{sq.m} / 78.93 ^{sq.m}

TERRACE AREA
78 ^{sq.m} / 7.22 ^{sq.m}

TOTAL AREA
928 ^{sq.m} / 86.15 ^{sq.m}

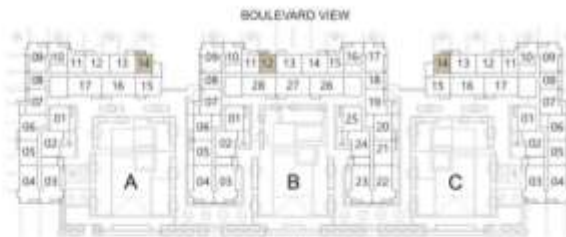

Level 03

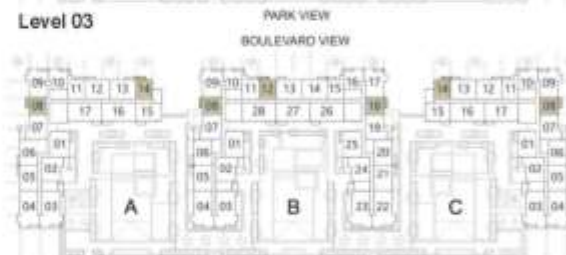

Levels 04-07

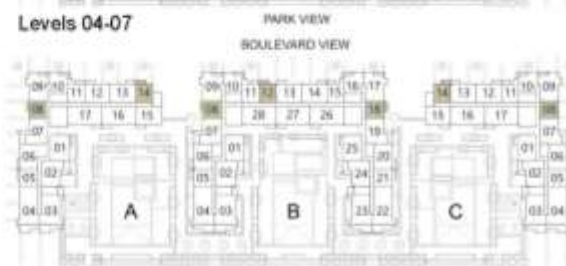

Level 08



1 BEDROOM (TYP.01)

1 BEDROOM - T2A

BLOCK A, B, C

LEVELS	UNITS
03	A-311, C-311
04	A-411, C-411
05	A-511, C-511
06	A-611, C-611
07	A-711, C-711
08	A-811, C-811

SUITE AREA
 917 ^{sqm} / 85.15 ^{sqm}
 TERRACE AREA
 73 ^{sqm} / 6.76 ^{sqm}
 TOTAL AREA
 990 ^{sqm} / 91.91 ^{sqm}

LEVELS	UNITS
03	B-311, B-315
04	B-411, B-415
05	B-511, B-515
06	B-611, B-615
07	B-711, B-715
08	B-811, B-815

SUITE AREA
 917 ^{sqm} / 85.15 ^{sqm}
 TERRACE AREA
 67 ^{sqm} / 6.26 ^{sqm}
 TOTAL AREA
 984 ^{sqm} / 91.41 ^{sqm}

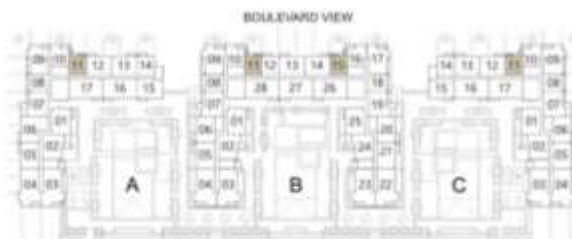

Level 03

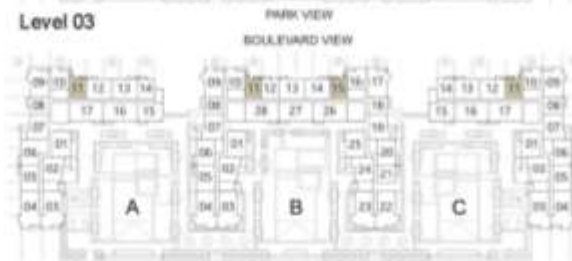

Levels 04-07

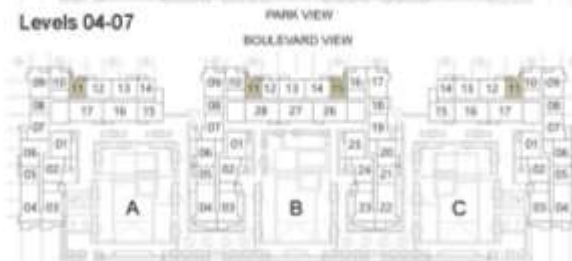

Level 08



1 BEDROOM (TYP.02)

1 BEDROOM - T3A

BLOCK A, B, C

LEVELS	UNITS
03	A-310, B-310, B-316, C-310
04	A-410, B-410, B-416, C-410
05	A-510, B-510, B-516, C-510
06	A-610, B-610, B-616, C-610
07	A-710, B-710, B-716, C-710
08	A-810, B-810, B-816, C-810

SLATE AREA
970 sq.ft. / 90.12 sq.m.

TERRACE AREA
87 sq.ft. / 8.05 sq.m.

TOTAL AREA
1057 sq.ft. / 98.17 sq.m.



1 BEDROOM (TYP.03)

2 BEDROOM - T1A

BLOCK A, B, C

LEVELS	UNITS
01	A-101, B-101, B-114, C-101
02	A-301, 305, 306, 313 B-301, 305, 306, 313 314, 320, 321, 325 C-301, 305, 306, 313
04	A-401 B-401, 405, 406, 413 414, 420, 421, 425 C-401
05	A-501 B-501, 505, 506, 513 514, 520, 521, 525 C-501
06	A-601 B-601, 605, 606, 613 614, 620, 621, 625 C-601
07	A-701 B-701, 705, 706, 713 714, 720, 721, 725 C-701

SUITE AREA
1264 ^{sq.ft.} / 117.4 ^{sq.m.}

TERRACE AREA
78 ^{sq.ft.} / 7.22 ^{sq.m.}

TOTAL AREA
1342 ^{sq.ft.} / 124.62 ^{sq.m.}

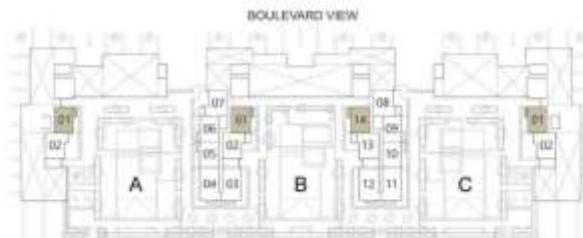

Level 01

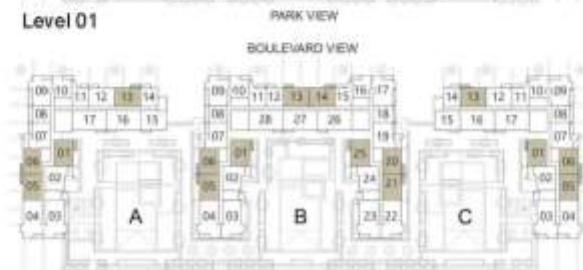

Level 03

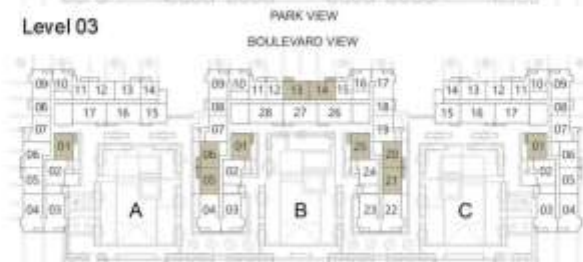

Levels 04-07



2 BEDROOM (TYP.01)

2 BEDROOM - T1D

BLOCK A, B, C

LEVELS	UNITS
G	A-G01, B-G01, B-G14, C-G01

SUITE AREA
1264 ^{sq.ft.} / 117.40 ^{sq.m.}

TERRACE AREA
400 ^{sq.ft.} / 37.15 ^{sq.m.}

TOTAL AREA
1664 ^{sq.ft.} / 154.55 ^{sq.m.}

LEVELS	UNITS
G	B-G01, B-G04, B-G09, B-G10

SUITE AREA
1264 ^{sq.ft.} / 117.40 ^{sq.m.}

TERRACE AREA
393 ^{sq.ft.} / 36.52 ^{sq.m.}

TOTAL AREA
1657 ^{sq.ft.} / 153.92 ^{sq.m.}

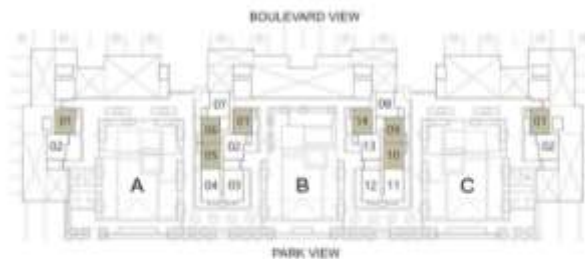

Level G



2 BEDROOM (TYP.01 G LEVEL)

2 BEDROOM - T2A

BLOCK A, B, C

LEVELS	UNITS
03	A-302, B-302, B-324, C-302
04	A-402, B-402, B-424, C-402
05	A-502, B-502, B-524, C-502
06	A-602, B-602, B-624, C-602
07	A-702, B-702, B-724, C-702
08	A-802, B-802, B-824, C-802

SLATE AREA
1352 ^{sq.ft.} / 125.60 ^{sq.m.}

TERRACE AREA
251 ^{sq.ft.} / 23.34 ^{sq.m.}

TOTAL AREA
1603 ^{sq.ft.} / 148.94 ^{sq.m.}

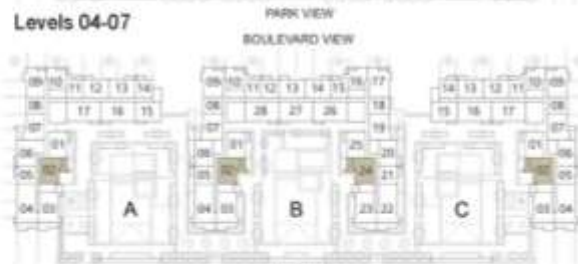
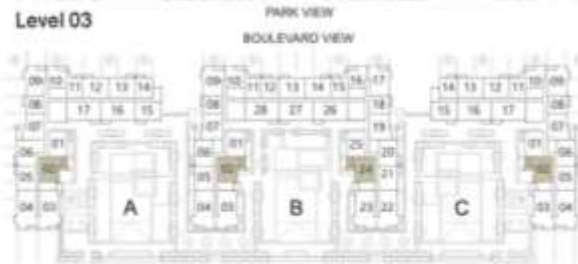
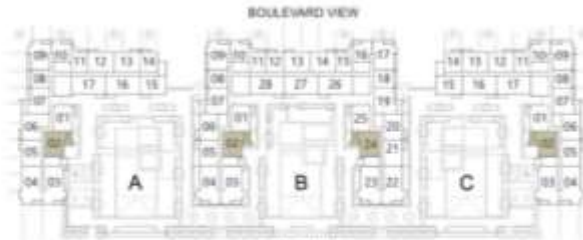

2 BEDROOM (TYP.02)

2 BEDROOM - T5A

BLOCK A, B, C

LEVELS	UNITS
G	A-G02, C-G02
SUITE AREA	
1352	sq.ft. / 125.61
TERRACE AREA	
460	sq.ft. / 42.73
TOTAL AREA	
1812	sq.ft. / 168.34

LEVELS	UNITS
G	B-G02, B-G13
SUITE AREA	
1352	sq.ft. / 125.61
TERRACE AREA	
461	sq.ft. / 42.81
TOTAL AREA	
1813	sq.ft. / 168.42

LEVELS	UNITS
G	B-G07, B-G08
SUITE AREA	
1350	sq.ft. / 125.38
TERRACE AREA	
449	sq.ft. / 41.73
TOTAL AREA	
1799	sq.ft. / 167.11

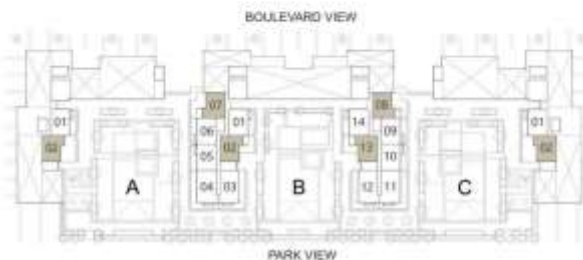

Level G



2 BEDROOM (TYP.02 G LEVEL)

2 BEDROOM - T3A

BLOCK A, C

LEVELS	UNITS
04	A-805, C-809
05	A-509, C-509
06	A-809, C-809
07	A-709, C-709
08	A-809, C-809

SUITE AREA
1487 ^{sq.ft.} / 138.16 ^{sq.m.}

TERRACE AREA
85 ^{sq.ft.} / 7.92 ^{sq.m.}

TOTAL AREA
1572 ^{sq.ft.} / 146.08 ^{sq.m.}

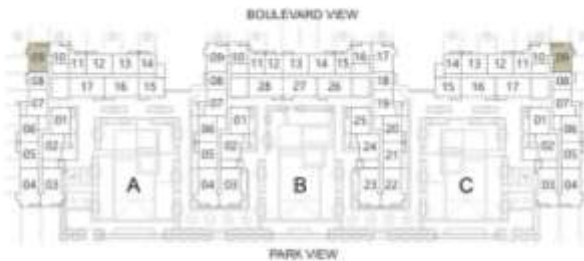

Levels 04-07

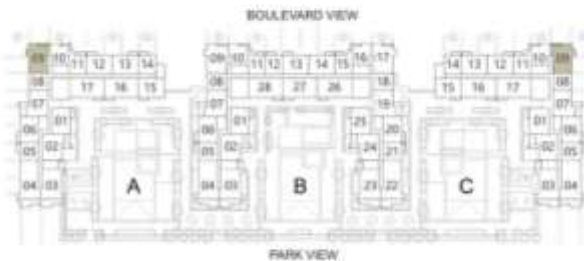

Level 08



2 BEDROOM (TYP.03)

2 BEDROOM - T6A

BLOCK A, B, C

LEVELS	UNITS
08	A-803, C-803

SUITE AREA
1581 sq.ft. / 146.87 sq.m.

TERRACE AREA
540 sq.ft. / 50.17 sq.m.

TOTAL AREA
2121 sq.ft. / 197.04 sq.m.

LEVELS	UNITS
08	B-803, B-823

SUITE AREA
1582 sq.ft. / 146.93 sq.m.

TERRACE AREA
540 sq.ft. / 50.17 sq.m.

TOTAL AREA
2122 sq.ft. / 197.10 sq.m.

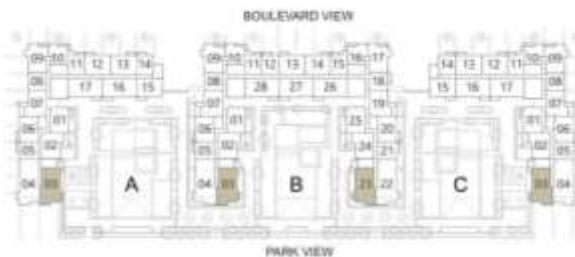

Level 08



2 BEDROOM (TYP.03)

3 BEDROOM - T1A

BLOCK A, B, C

LEVELS	UNITS
03	A-316, B-327, C-319
04	A-416, B-427, C-416
05	A-516, B-527, C-516
06	A-616, B-627, C-616
07	A-716, B-727, C-716
08	A-816, B-827, C-816

SUITE AREA
 1681 ^{sq.ft.} / 156.15 ^{sq.m.}
 TERRACE AREA
 78 ^{sq.ft.} / 7.22 ^{sq.m.}
 TOTAL AREA
 1759 ^{sq.ft.} / 163.37 ^{sq.m.}

LEVELS	UNITS
03	A-317, C-317
04	A-417, C-417
05	A-517, C-517
06	A-617, C-617
07	A-717, C-717
08	A-817, C-817

SUITE AREA
 1688 ^{sq.ft.} / 156.81 ^{sq.m.}
 TERRACE AREA
 78 ^{sq.ft.} / 7.22 ^{sq.m.}
 TOTAL AREA
 1766 ^{sq.ft.} / 164.03 ^{sq.m.}

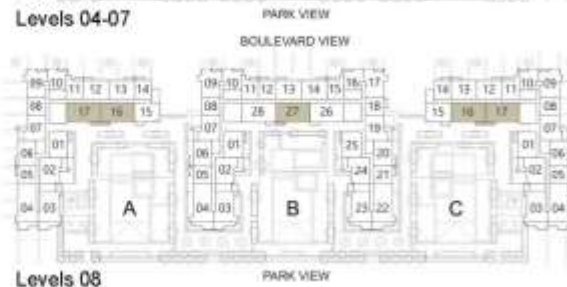
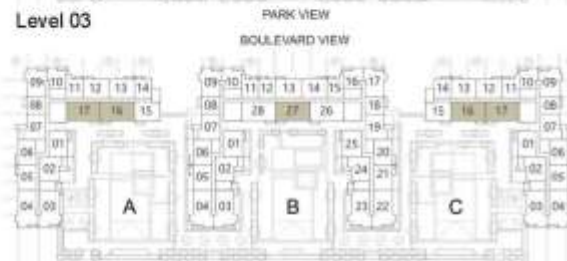

3 BEDROOM (TYP.01)

3 BEDROOM - T2A

BLOCK B

LEVELS	UNITS
03	B-3D4, B-322
04	B-4D4, B-422
05	B-5D4, B-522
06	B-6D4, B-622
07	B-7D4, B-722

SUITE AREA
1903 sq.ft. / 176.81 sq.m.

TERRACE AREA
87 sq.ft. / 8.05 sq.m.

TOTAL AREA
1990 sq.ft. / 184.86 sq.m.

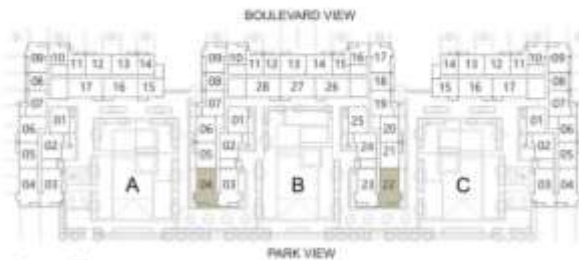

Level 03

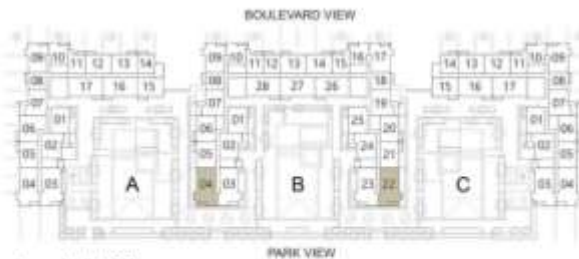

Levels 04-07



3 BEDROOM (TYP.02)

3 BEDROOM - T3A

BLOCK B

LEVELS	UNITS
G	B-G03, B-G12

SITE AREA
1680 ^{sq.ft.} / 156.04 ^{sq.m.}

TERRACE AREA
889 ^{sq.ft.} / 82.59 ^{sq.m.}

TOTAL AREA
2569 ^{sq.ft.} / 238.63 ^{sq.m.}

LEVELS	UNITS
G	B-G04, B-G11

SITE AREA
1675 ^{sq.ft.} / 155.59 ^{sq.m.}

TERRACE AREA
885 ^{sq.ft.} / 82.18 ^{sq.m.}

TOTAL AREA
2560 ^{sq.ft.} / 237.77 ^{sq.m.}

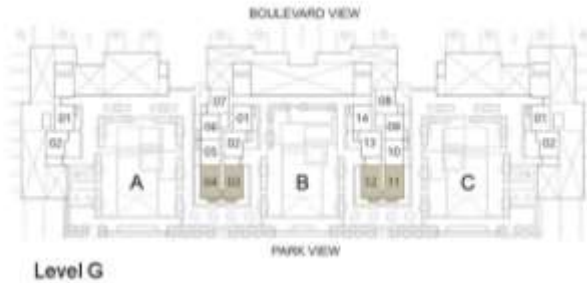

Level G



3 BEDROOM (TYP.02 G LEVEL)

3 BEDROOM - T4A

BLOCK A, B, C

LEVELS	UNITS
08	A-804, C-804

SUITE AREA
1972 sq.ft. / 183.18 sq.m.

TERRACE AREA
362 sq.ft. / 33.61 sq.m.

TOTAL AREA
2334 sq.ft. / 216.79 sq.m.

LEVELS	UNITS
08	B-804, B-822

SUITE AREA
1972 sq.ft. / 183.18 sq.m.

TERRACE AREA
363 sq.ft. / 33.69 sq.m.

TOTAL AREA
2335 sq.ft. / 216.87 sq.m.

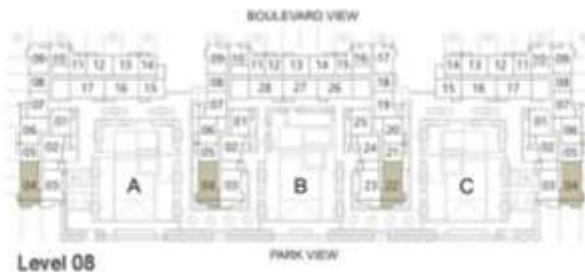

3 BEDROOM (TYP.03)

THANK YOU.